



**LEGEND**

- . . SEWER MANHOLE
- . . SEWER MAINTENANCE SHAFT
- . . SEWER RODDING END
- . . STORMWATER MANHOLE
- . . GULLY TRAP
- . . WATER METER
- . . FIRE HYDRANT
- . . STOP VALVE
- . . ELECTRICITY PILLAR
- . . COMMS PIT
- . . RING MAIN UNIT
- . . LIGHT POLE
- . . DESIGN CONTOURS
- . . EXISTING SURFACE CONTOURS
- . . DESIGN FILL
- S-S- SEWERAGE
- SW-SW- STORMWATER
- W-W- WATER PIPE
- UE-UE- UNDERGROUND ELECTRICITY
- T-T- COMMS LINE
- . . OPTIONAL BUILT TO BOUNDARY WALL
- FSL 3.44 FINISHED SURFACE LEVEL
- . . RETAINING WALL
- . . FOOTPATH
- RH 0.9 RETAINING WALL HEIGHT

**Notes:**

- Final areas are subject to design changes, Council approval and field survey and may differ from those shown on this Disclosure Plan.
- Final presentation of areas will comply with requirements of the Registrar of Titles and may vary from the format on this Disclosure Plan
- "The Seller is entitled to make a Permitted Variation (as defined in Special Condition 3 of the contract) to the lot including its location, area, size, dimensions and elevation".
- Design contours are approximate only and may change during construction
- Services have been plotted from design information only and may change during construction
- All earthworks fill to lots has been placed and compacted on Level 1 basis in accordance with Australian Standard AS3798-2007 "Guidelines on earthworks for commercial and residential developments".

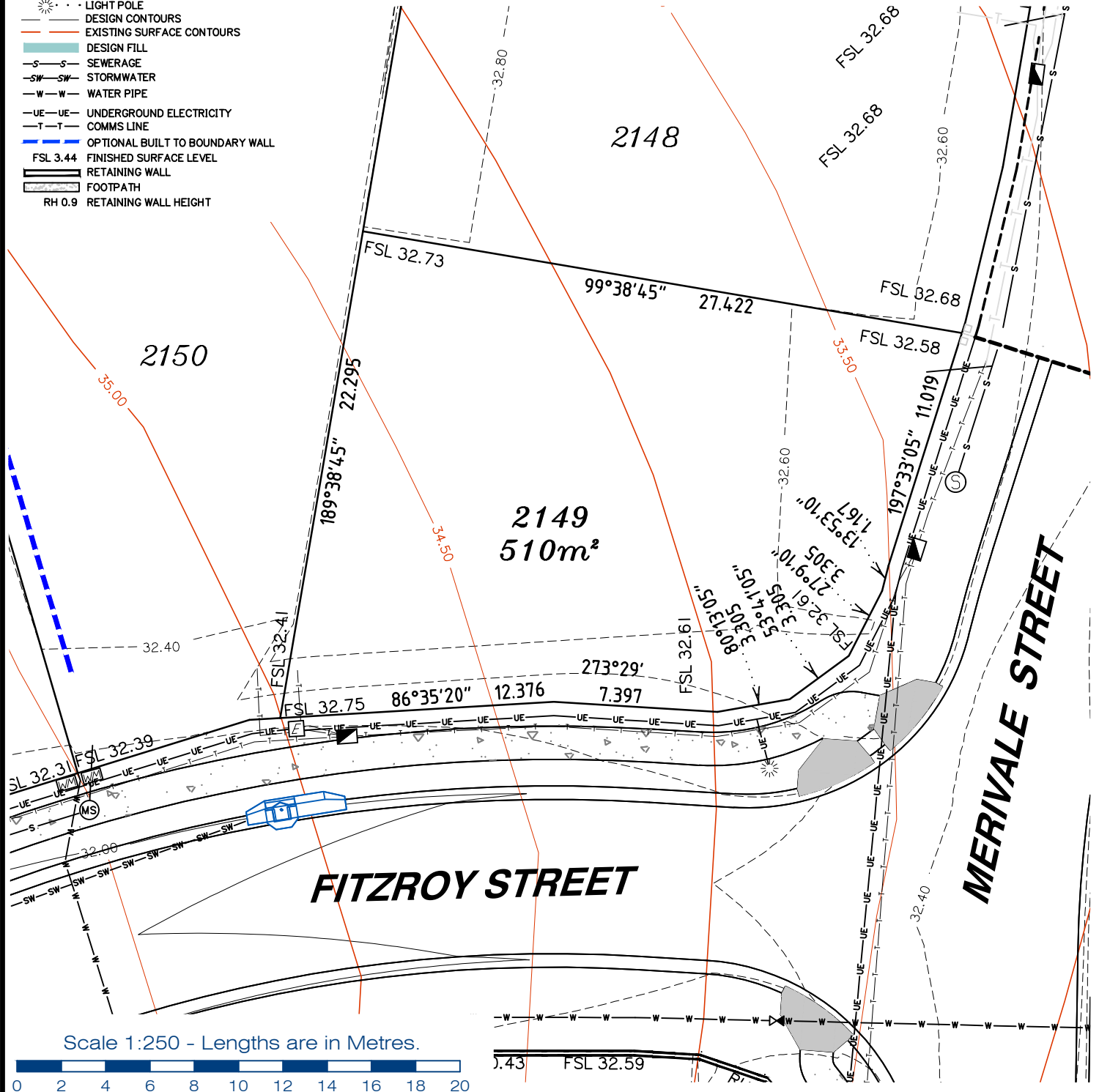

Scale 1:250 - Lengths are in Metres.



planning | environment | landscape | engineering | survey

T: 3807 3333 | F: 3287 5461 | www.gassman.com.au

LOGAN & Logan | 176 Business Street, Yatala QLD | PO Box 392, Beenleigh 4207

|         |  |
|---------|--|
| Client  | <b>AVJENNINGS Pty Ltd</b>  |
| Project | <b>DISCLOSURE PLAN</b><br><b>LOT 2149</b><br>(Survey plan: SP280869)<br><b>RIVERTON</b><br><b>Cusack Lane, Jimboomba</b> |

|                        |                    |                  |                               |
|------------------------|--------------------|------------------|-------------------------------|
| Locality               | JIMBOOMBA          | Issue Date       | 20/09/2021                    |
| Local Govt             | LOGAN CITY COUNCIL | Meridian         | SP280865                      |
| Scale (on A4 original) | 1:250              | Level Datum      | AHD                           |
|                        |                    | Contour Interval | 0.2 m Design<br>0.5m Existing |
|                        |                    | Drawn            | S.Chowdhury                   |
|                        |                    | Date Drafted     | 20/08/2021                    |
|                        |                    | Checked          | A.Geraghty                    |

**Real Property Description:**  
Lot 701 on SP280865

REFERENCE No. **5544-2C**  
PLAN No. **5544 S DC LOT 2149**



**LEGEND**

- . SEWER MANHOLE
- . SEWER MAINTENANCE SHAFT
- . SEWER RODDING END
- . STORMWATER MANHOLE
- . GULLY TRAP
- . WATER METER
- . FIRE HYDRANT
- . STOP VALVE
- . ELECTRICITY PILLAR
- . COMMS PIT
- . RING MAIN UNIT
- . LIGHT POLE
- . DESIGN CONTOURS
- . EXISTING SURFACE CONTOURS
- . DESIGN FILL
- . S S SEWERAGE
- . SW SW STORMWATER
- . W W WATER PIPE
- . UE UE UNDERGROUND ELECTRICITY
- . T T COMMS LINE
- . OPTIONAL BUILT TO BOUNDARY WALL
- . FSL 3.44 FINISHED SURFACE LEVEL
- . RETAINING WALL
- . FOOTPATH
- . RH 0.9 RETAINING WALL HEIGHT

**Notes:**

- Final areas are subject to design changes, Council approval and field survey and may differ from those shown on this Disclosure Plan.
- Final presentation of areas will comply with requirements of the Registrar of Titles and may vary from the format on this Disclosure Plan
- "The Seller is entitled to make a Permitted Variation (as defined in Special Condition 3 of the contract) to the lot including its location, area, size, dimensions and elevation".
- Design contours are approximate only and may change during construction
- Services have been plotted from design information only and may change during construction
- All earthworks fill to lots has been placed and compacted on Level 1 basis in accordance with Australian Standard AS3798-2007 "Guidelines on earthworks for commercial and residential developments".

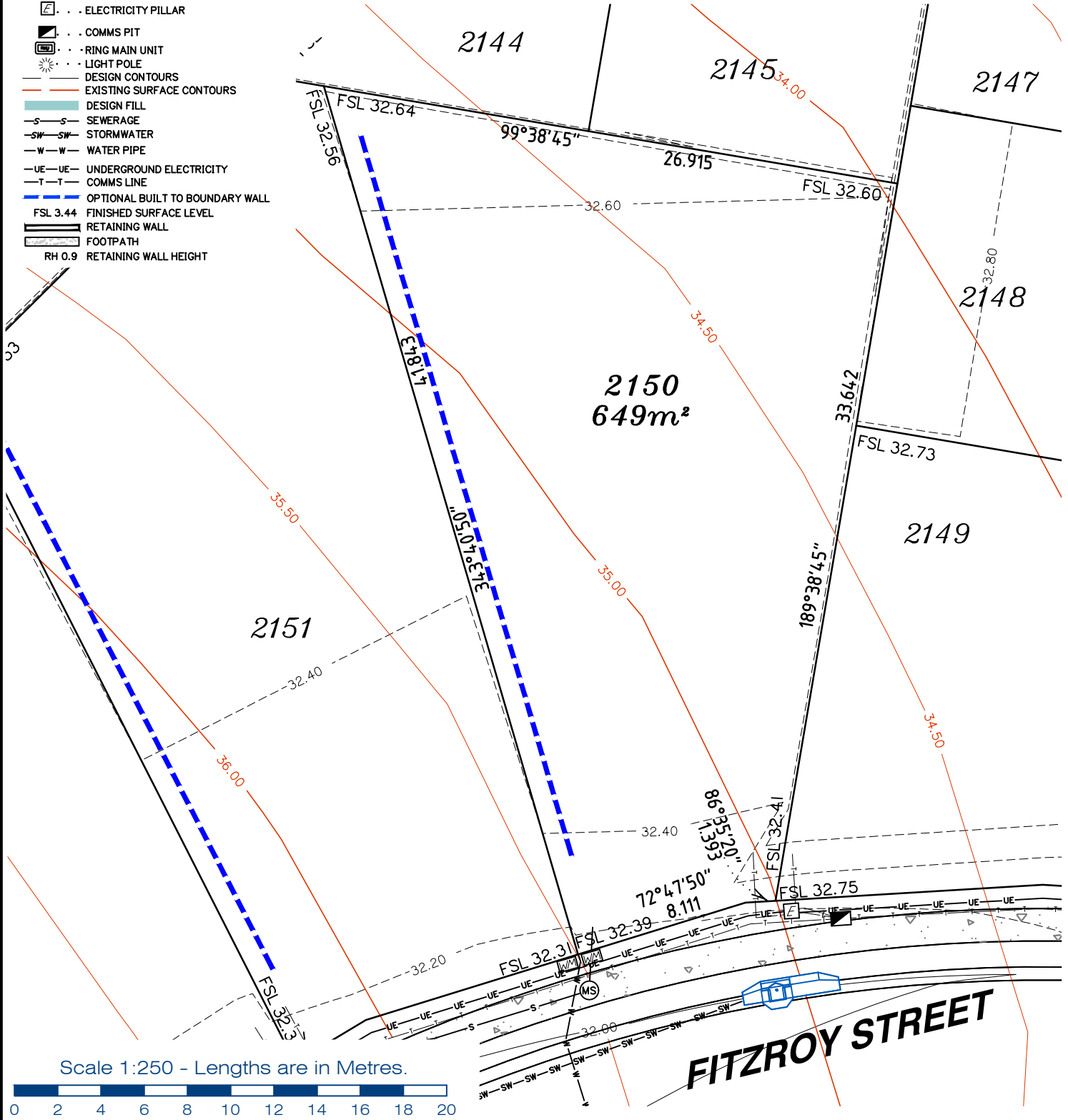

Scale 1:250 - Lengths are in Metres.

**gassman development perspectives**  
 est 1985  
 planning | environment | landscape | engineering | survey  
 T: 3807 3333 | F: 3287 5461 | www.gassman.com.au  
 LOGAN & Logan | 76 Business Street, Yatala QLD | PO Box 392, Beenleigh 4207

|         |  |
|---------|--|
| Client  | <b>AVJENNINGS Pty Ltd</b>  |
| Project | <b>DISCLOSURE PLAN</b><br><b>LOT 2150</b><br>(Survey plan: SP280869)<br><b>RIVERTON</b><br><b>Cusack Lane, Jimboomba</b> |

|                        |                    |                  |                               |
|------------------------|--------------------|------------------|-------------------------------|
| Locality               | JIMBOOMBA          | Issue Date       | 20/09/2021                    |
| Local Govt             | LOGAN CITY COUNCIL | Meridian         | SP280865                      |
| Scale (on A4 original) | 1:250              | Level Datum      | AHD                           |
|                        |                    | Contour Interval | 0.2 m Design<br>0.5m Existing |
|                        |                    | Drawn            | S.Chowdhury                   |
|                        |                    | Date Drafted     | 20/08/2021                    |
|                        |                    | Checked          | A.Geraghty                    |

**Real Property Description:**  
 Lot 701 on SP280865

**REFERENCE No. 5544-2C**  
**PLAN No. 5544 S DC LOT 2150**



**LEGEND**

- . SEWER MANHOLE
- . SEWER MAINTENANCE SHAFT
- . SEWER RODDING END
- . STORMWATER MANHOLE
- . GULLY TRAP
- . WATER METER
- . FIRE HYDRANT
- . STOP VALVE
- . ELECTRICITY PILLAR
- . COMMS PIT
- . RING MAIN UNIT
- . LIGHT POLE
- . DESIGN CONTOURS
- . EXISTING SURFACE CONTOURS
- . DESIGN FILL
- . SEWERAGE
- . STORMWATER
- . WATER PIPE
- . UNDERGROUND ELECTRICITY
- . COMMS LINE
- . OPTIONAL BUILT TO BOUNDARY WALL
- . FINISHED SURFACE LEVEL
- . RETAINING WALL
- . FOOTPATH
- . RH 0.9 RETAINING WALL HEIGHT

**Notes:**

- Final areas are subject to design changes, Council approval and field survey and may differ from those shown on this Disclosure Plan.
- Final presentation of areas will comply with requirements of the Registrar of Titles and may vary from the format on this Disclosure Plan
- "The Seller is entitled to make a Permitted Variation (as defined in Special Condition 3 of the contract) to the lot including its location, area, size, dimensions and elevation".
- Design contours are approximate only and may change during construction
- Services have been plotted from design information only and may change during construction
- All earthworks fill to lots has been placed and compacted on Level 1 basis in accordance with Australian Standard AS3798-2007 "Guidelines on earthworks for commercial and residential developments".

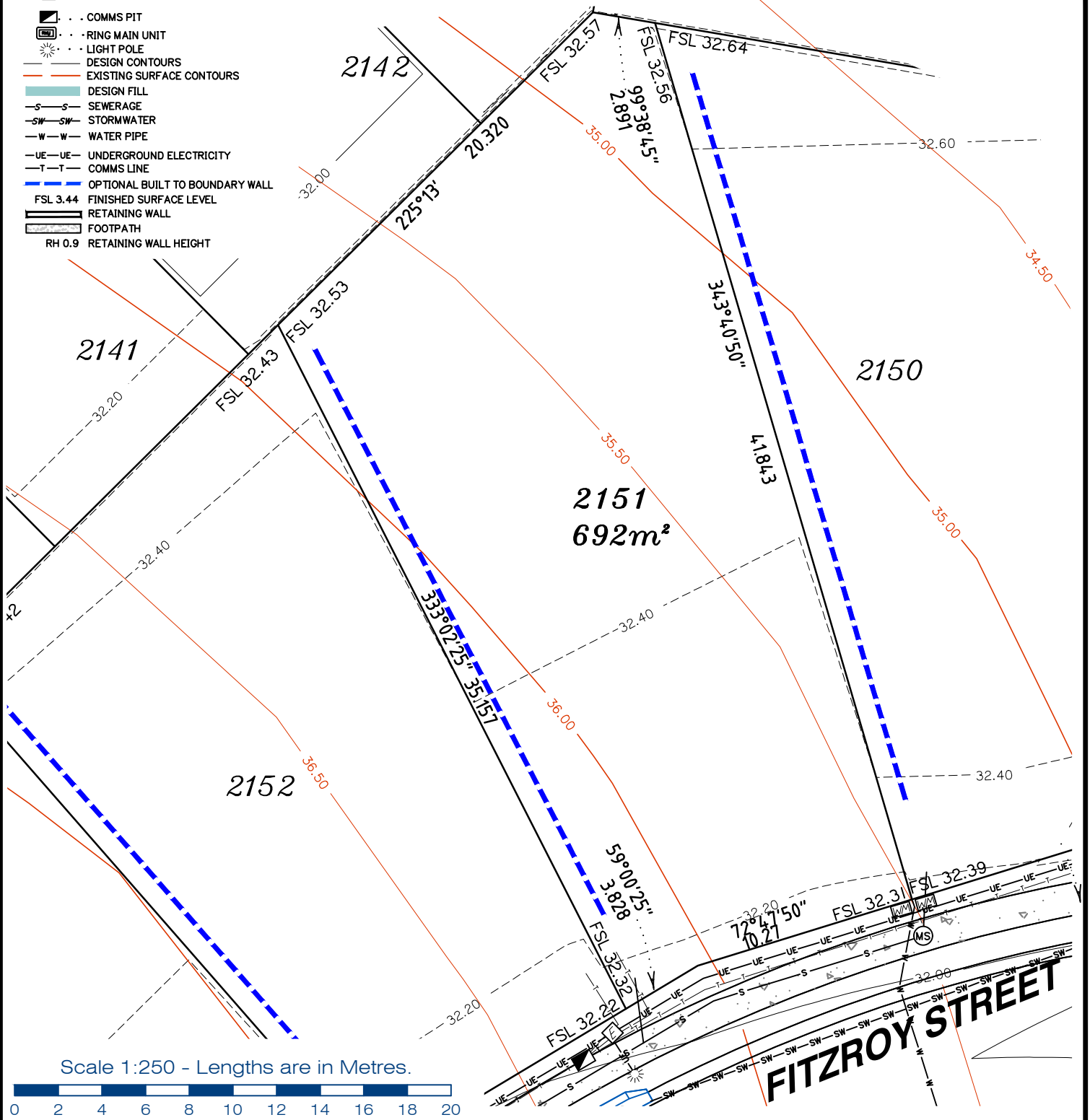

Scale 1:250 - Lengths are in Metres.



**gassman development perspectives**  
 est 1985  
 planning | environment | landscape | engineering | survey  
 T: 3807 3333 | F: 3287 5461 | www.gassman.com.au  
 LOGAN & Logan | 176 Business Street, Yatala QLD | PO Box 392, Beenleigh 4207

|         |  |
|---------|--|
| Client  | <b>AVJENNINGS Pty Ltd</b>  |
| Project | <b>DISCLOSURE PLAN</b><br><b>LOT 2151</b><br>(Survey plan: SP280869)<br><b>RIVERTON</b><br><b>Cusack Lane, Jimboomba</b> |

|                        |                    |                  |                               |
|------------------------|--------------------|------------------|-------------------------------|
| Locality               | JIMBOOMBA          | Issue Date       | 20/09/2021                    |
| Local Govt             | LOGAN CITY COUNCIL | Meridian         | SP280865                      |
| Scale (on A4 original) | 1:250              | Level Datum      | AHD                           |
|                        |                    | Contour Interval | 0.2 m Design<br>0.5m Existing |
|                        |                    | Drawn            | S.Chowdhury                   |
|                        |                    | Date Drafted     | 20/08/2021                    |
|                        |                    | Checked          | A.Geraghty                    |

**Real Property Description:**  
Lot 701 on SP280865

**REFERENCE No. 5544-2C**  
**PLAN No. 5544 S DC LOT 2151**



**LEGEND**

- . . SEWER MANHOLE
- . . SEWER MAINTENANCE SHAFT
- . . SEWER RODDING END
- . . STORMWATER MANHOLE
- . . GULLY TRAP
- . . WATER METER
- . . FIRE HYDRANT
- . . STOP VALVE
- . . ELECTRICITY PILLAR

- . . COMMS PIT
- . . RING MAIN UNIT
- . . LIGHT POLE
- . . DESIGN CONTOURS
- . . EXISTING SURFACE CONTOURS
- . . DESIGN FILL
- . . SEWERAGE
- . . STORMWATER
- . . WATER PIPE
- . . UNDERGROUND ELECTRICITY
- . . COMMS LINE
- . . OPTIONAL BUILT TO BOUNDARY WALL
- . . FINISHED SURFACE LEVEL
- . . RETAINING WALL
- . . FOOTPATH
- . . RH 0.9 RETAINING WALL HEIGHT

**Notes:**

- Final areas are subject to design changes, Council approval and field survey and may differ from those shown on this Disclosure Plan.
- Final presentation of areas will comply with requirements of the Registrar of Titles and may vary from the format on this Disclosure Plan
- "The Seller is entitled to make a Permitted Variation (as defined in Special Condition 3 of the contract) to the lot including its location, area, size, dimensions and elevation".
- Design contours are approximate only and may change during construction
- Services have been plotted from design information only and may change during construction
- All earthworks fill to lots has been placed and compacted on Level 1 basis in accordance with Australian Standard AS3798-2007 "Guidelines on earthworks for commercial and residential developments".

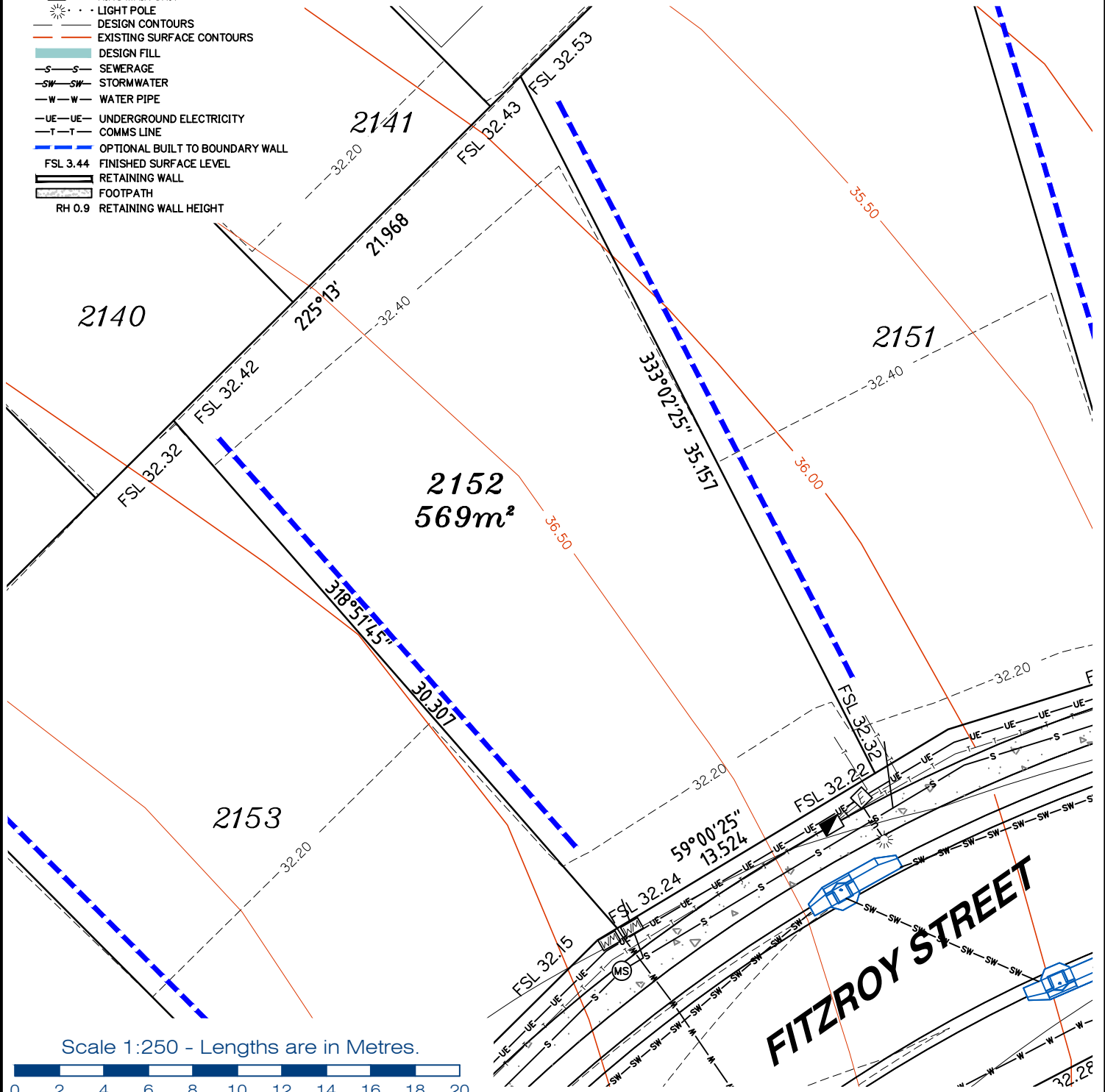

Scale 1:250 - Lengths are in Metres.



**gassman development perspectives**  
 est 1985  
 planning | environment | landscape | engineering | survey  
 T: 3807 3333 | F: 3287 5461 | www.gassman.com.au  
 LOGAN & Logan | 76 Business Street, Yatala QLD | PO Box 392, Beenleigh 4207

|         |  |
|---------|--|
| Client  | <b>AVJENNINGS Pty Ltd</b>  |
| Project | <b>DISCLOSURE PLAN</b><br><b>LOT 2152</b><br>(Survey plan: SP280869)<br><b>RIVERTON</b><br><b>Cusack Lane, Jimboomba</b> |

|                        |                    |                  |                               |
|------------------------|--------------------|------------------|-------------------------------|
| Locality               | JIMBOOMBA          | Issue Date       | 20/09/2021                    |
| Local Govt             | LOGAN CITY COUNCIL | Meridian         | SP280865                      |
| Scale (on A4 original) | 1:250              | Level Datum      | AHD                           |
|                        |                    | Contour Interval | 0.2 m Design<br>0.5m Existing |
|                        |                    | Drawn            | S.Chowdhury                   |
|                        |                    | Date Drafted     | 20/08/2021                    |
|                        |                    | Checked          | A.Geraghty                    |

**Real Property Description:**  
Lot 701 on SP280865

**REFERENCE No. 5544-2C**  
**PLAN No. 5544 S DC LOT 2152**

**LEGEND**

- . SEWER MANHOLE
- . SEWER MAINTENANCE SHAFT
- . SEWER RODDING END
- . STORMWATER MANHOLE
- . GULLY TRAP
- . WATER METER
- . FIRE HYDRANT
- . STOP VALVE
- . ELECTRICITY PILLAR
- . COMMS PIT
- . RING MAIN UNIT
- . LIGHT POLE
- DESIGN CONTOURS
- EXISTING SURFACE CONTOURS
- DESIGN FILL
- S—S— SEWERAGE
- SW—SW— STORMWATER
- W—W— WATER PIPE
- UE—UE— UNDERGROUND ELECTRICITY
- T—T— COMMS LINE
- OPTIONAL BUILT TO BOUNDARY WALL
- FSL 3.44 FINISHED SURFACE LEVEL
- RETAINING WALL
- FOOTPATH
- RH 0.9 RETAINING WALL HEIGHT

**Notes:**

- Final areas are subject to design changes, Council approval and field survey and may differ from those shown on this Disclosure Plan.
- Final presentation of areas will comply with requirements of the Registrar of Titles and may vary from the format on this Disclosure Plan
- "The Seller is entitled to make a Permitted Variation (as defined in Special Condition 3 of the contract) to the lot including its location, area, size, dimensions and elevation".
- Design contours are approximate only and may change during construction
- Services have been plotted from design information only and may change during construction
- All earthworks fill to lots has been placed and compacted on Level 1 basis in accordance with Australian Standard AS3798-2007 "Guidelines on earthworks for commercial and residential developments".

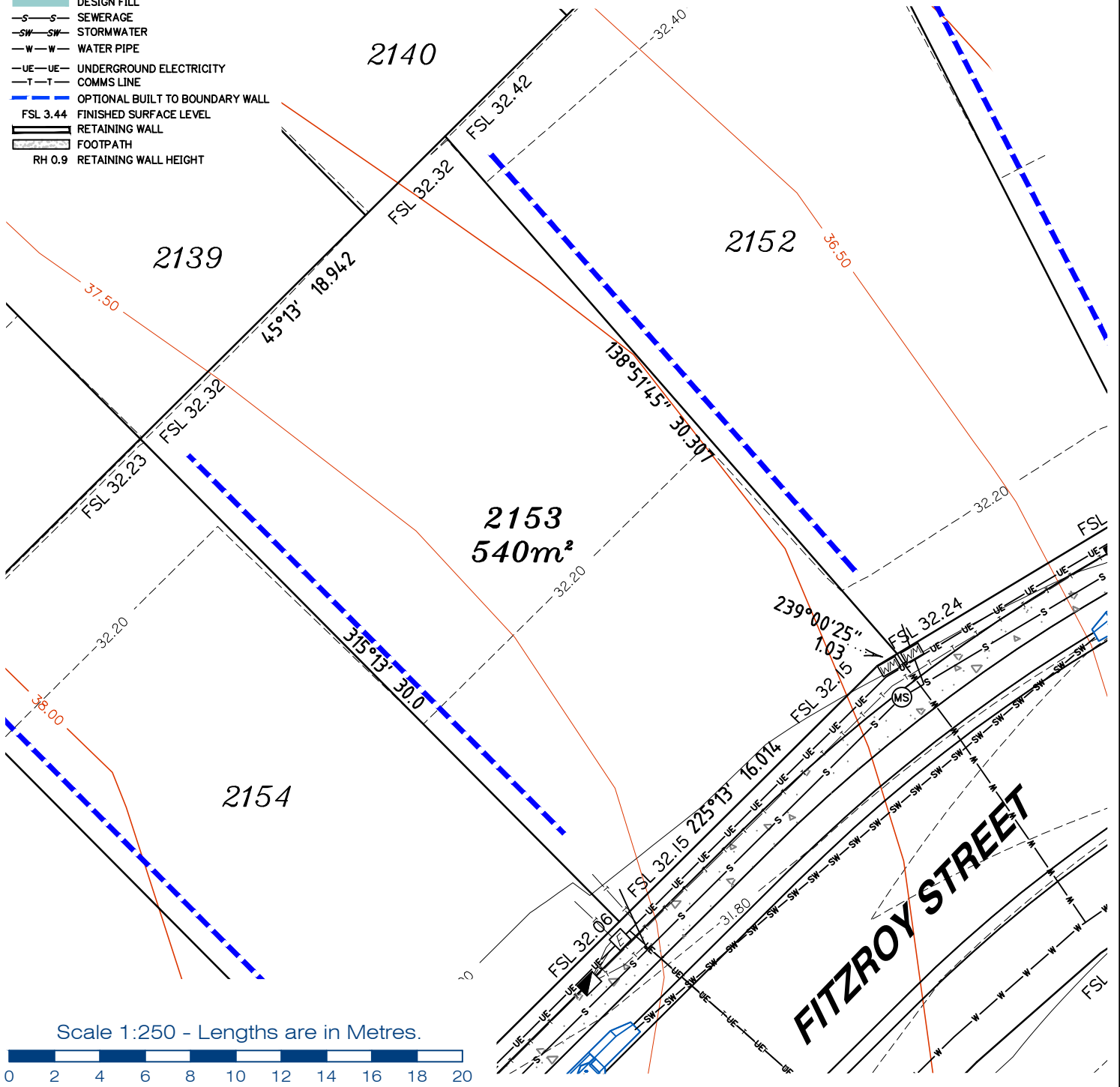

Scale 1:250 - Lengths are in Metres.



**gassman development perspectives**  
 est 1985  
 planning | environment | landscape | engineering | survey  
 T: 3807 3333 | F: 3287 5461 | www.gassman.com.au  
 LOGAN & Logan | 176 Business Street, Yatala QLD | PO Box 392, Beenleigh 4207

|         |  |
|---------|--|
| Client  | <b>AVJENNINGS Pty Ltd</b>  |
| Project | <b>DISCLOSURE PLAN</b><br><b>LOT 2153</b><br>(Survey plan: SP280869)<br><b>RIVERTON</b><br><b>Cusack Lane, Jimboomba</b> |

|                        |                    |                  |                               |
|------------------------|--------------------|------------------|-------------------------------|
| Locality               | JIMBOOMBA          | Issue Date       | 20/09/2021                    |
| Local Govt             | LOGAN CITY COUNCIL | Meridian         | SP280865                      |
| Scale (on A4 original) | 1:250              | Level Datum      | AHD                           |
|                        |                    | Contour Interval | 0.2 m Design<br>0.5m Existing |
|                        |                    | Drawn            | S.Chowdhury                   |
|                        |                    | Date Drafted     | 20/08/2021                    |
|                        |                    | Checked          | A.Geraghty                    |

**Real Property Description:**  
 Lot 701 on SP280865

**REFERENCE No. 5544-2C**  
**PLAN No. 5544 S DC LOT 2153**



**LEGEND**

- . . SEWER MANHOLE
- ⊗ . . SEWER MAINTENANCE SHAFT
- ⊙ . . SEWER RODDING END
- ⊕ . . STORMWATER MANHOLE
- ⊖ . . GULLY TRAP
- ⊗ . . WATER METER
- ⊕ . . FIRE HYDRANT
- ⊖ . . STOP VALVE
- ⊗ . . ELECTRICITY PILLAR

- ⊗ . . COMMS PIT
- ⊗ . . RING MAIN UNIT
- ⊗ . . LIGHT POLE

- . . DESIGN CONTOURS
- . . EXISTING SURFACE CONTOURS
- . . DESIGN FILL
- S—S— . . SEWERAGE
- SW—SW— . . STORMWATER
- W—W— . . WATER PIPE
- UE—UE— . . UNDERGROUND ELECTRICITY
- T—T— . . COMMS LINE
- . . OPTIONAL BUILT TO BOUNDARY WALL
- FSL 3.44 . . FINISHED SURFACE LEVEL
- . . RETAINING WALL
- . . FOOTPATH
- RH 0.9 . . RETAINING WALL HEIGHT

**Notes:**

- Final areas are subject to design changes, Council approval and field survey and may differ from those shown on this Disclosure Plan.
- Final presentation of areas will comply with requirements of the Registrar of Titles and may vary from the format on this Disclosure Plan
- "The Seller is entitled to make a Permitted Variation (as defined in Special Condition 3 of the contract) to the lot including its location, area, size, dimensions and elevation".
- Design contours are approximate only and may change during construction
- Services have been plotted from design information only and may change during construction
- All earthworks fill to lots has been placed and compacted on Level 1 basis in accordance with Australian Standard AS3798-2007 "Guidelines on earthworks for commercial and residential developments".

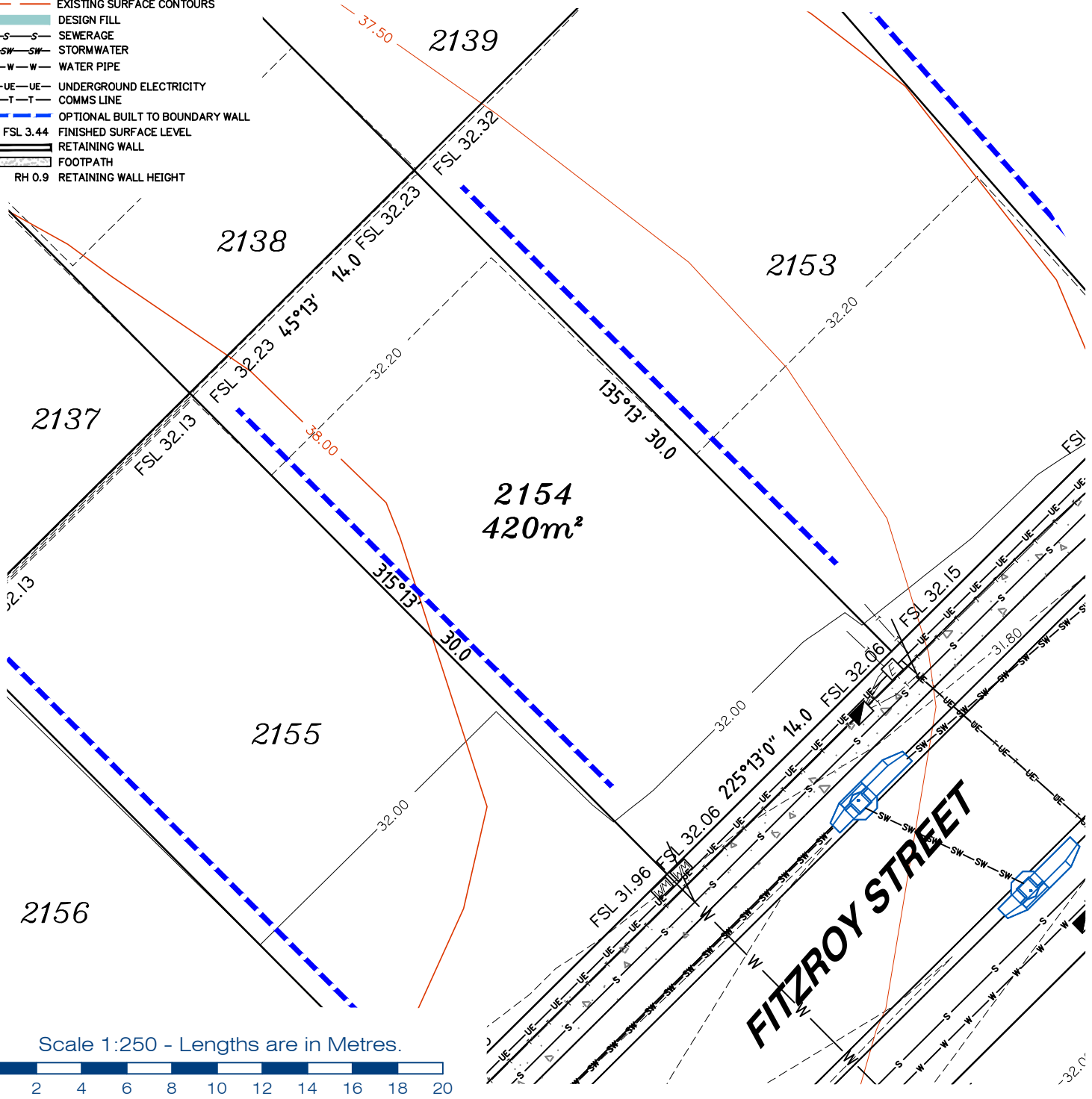

**gassman**  
**development**  
**perspectives**

est 1985

planning | environment | landscape | engineering | survey

T: 3807 3333 | F: 3287 5461 | www.gassman.com.au

LOGAN & Logan | 176 Business Street, Yatala QLD | PO Box 392, Beenleigh 4207

|         |  |
|---------|--|
| Client  | <b>AVJENNINGS Pty Ltd</b>  |
| Project | <b>DISCLOSURE PLAN</b><br><b>LOT 2154</b><br>(Survey plan: SP280869)<br><b>RIVERTON</b><br><b>Cusack Lane, Jimboomba</b> |

|                        |                    |                  |                               |
|------------------------|--------------------|------------------|-------------------------------|
| Locality               | JIMBOOMBA          | Issue Date       | 20/09/2021                    |
| Local Govt             | LOGAN CITY COUNCIL | Meridian         | SP280865                      |
| Scale (on A4 original) | 1:250              | Level Datum      | AHD                           |
|                        |                    | Contour Interval | 0.2 m Design<br>0.5m Existing |
|                        |                    | Drawn            | S.Chowdhury                   |
|                        |                    | Date Drafted     | 20/08/2021                    |
|                        |                    | Checked          | A.Geraghty                    |

**Real Property Description:**  
Lot 701 on SP280865

REFERENCE No. **5544-2C**  
PLAN No. **5544 S DC LOT 2154**



**LEGEND**

- . . SEWER MANHOLE
- . . SEWER MAINTENANCE SHAFT
- . . SEWER RODDING END
- . . STORMWATER MANHOLE
- . . GULLY TRAP
- . . WATER METER
- . . FIRE HYDRANT
- . . STOP VALVE
- . . ELECTRICITY PILLAR
- . . COMMS PIT
- . . RING MAIN UNIT
- . . LIGHT POLE
- DESIGN CONTOURS
- EXISTING SURFACE CONTOURS
- DESIGN FILL
- SEWERAGE
- STORMWATER
- WATER PIPE
- UNDERGROUND ELECTRICITY
- COMMS LINE
- OPTIONAL BUILT TO BOUNDARY WALL
- FSL 3.44 FINISHED SURFACE LEVEL
- RETAINING WALL
- FOOTPATH
- RH 0.9 RETAINING WALL HEIGHT

**Notes:**

- Final areas are subject to design changes, Council approval and field survey and may differ from those shown on this Disclosure Plan.
- Final presentation of areas will comply with requirements of the Registrar of Titles and may vary from the format on this Disclosure Plan
- "The Seller is entitled to make a Permitted Variation (as defined in Special Condition 3 of the contract) to the lot including its location, area, size, dimensions and elevation".
- Design contours are approximate only and may change during construction
- Services have been plotted from design information only and may change during construction
- All earthworks fill to lots has been placed and compacted on Level 1 basis in accordance with Australian Standard AS3798-2007 "Guidelines on earthworks for commercial and residential developments".

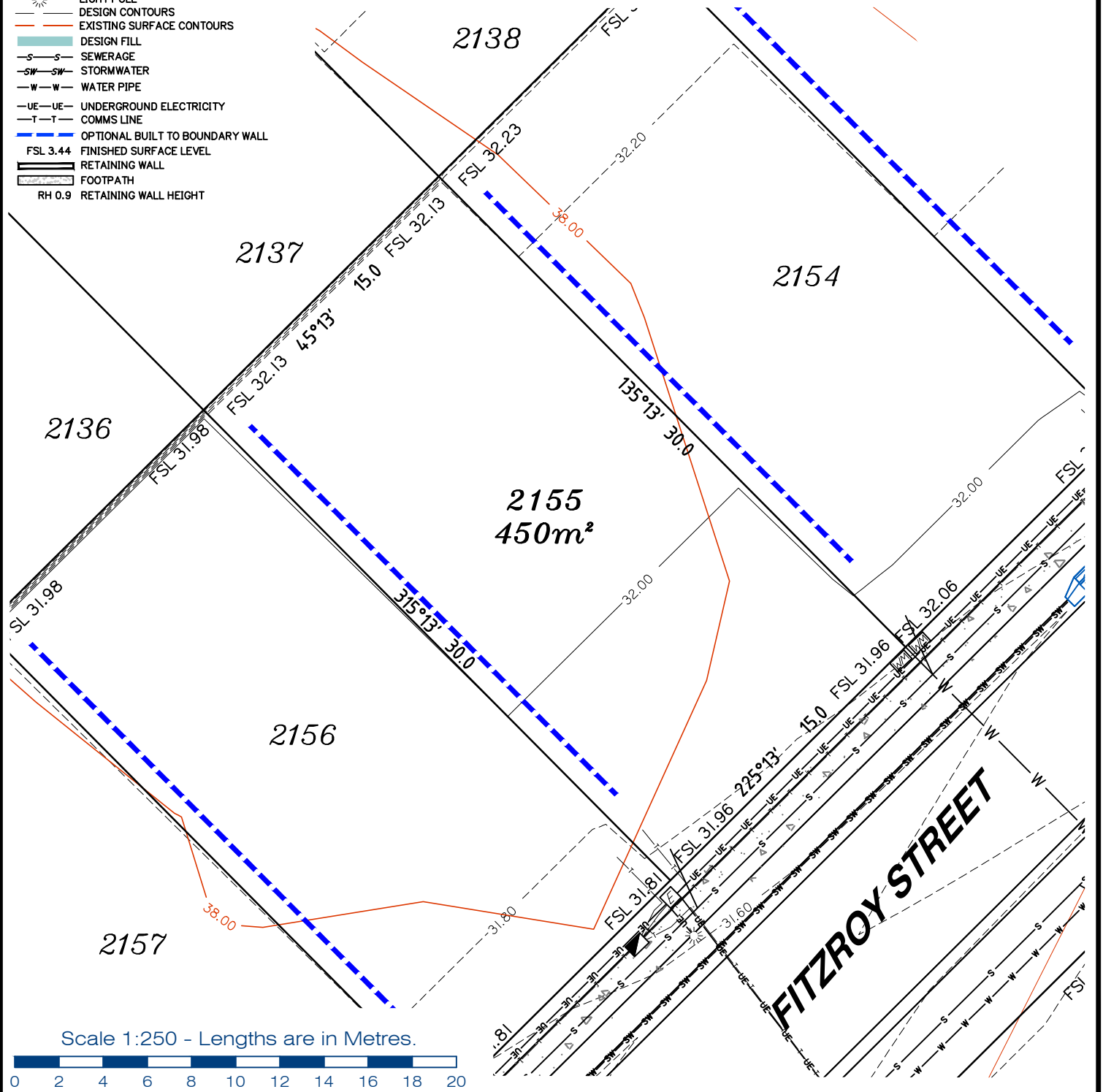

**gassman development perspectives**

planning | environment | landscape | engineering | survey

T: 3807 3333 | F: 3287 5461 | www.gassman.com.au

LOGAN & Logan | 76 Business Street, Yatala QLD | PO Box 392, Beenleigh 4207

|         |  |
|---------|--|
| Client  | <b>AVJENNINGS Pty Ltd</b>  |
| Project | <b>DISCLOSURE PLAN</b><br><b>LOT 2155</b><br>(Survey plan: SP280869)<br><b>RIVERTON</b><br><b>Cusack Lane, Jimboomba</b> |

|                        |                    |                  |                               |
|------------------------|--------------------|------------------|-------------------------------|
| Locality               | JIMBOOMBA          | Issue Date       | 20/09/2021                    |
| Local Govt             | LOGAN CITY COUNCIL | Meridian         | SP280865                      |
| Scale (on A4 original) | 1:250              | Level Datum      | AHD                           |
|                        |                    | Contour Interval | 0.2 m Design<br>0.5m Existing |
|                        |                    | Drawn            | S.Chowdhury                   |
|                        |                    | Date Drafted     | 20/08/2021                    |
|                        |                    | Checked          | A.Geraghty                    |

**Real Property Description:**  
Lot 701 on SP280865

REFERENCE No. **5544-2C**  
PLAN No. **5544 S DC LOT 2155**



**LEGEND**

- . . SEWER MANHOLE
- . . SEWER MAINTENANCE SHAFT
- . . SEWER RODDING END
- . . STORMWATER MANHOLE
- . . GULLY TRAP
- . . WATER METER
- . . FIRE HYDRANT
- . . STOP VALVE
- . . ELECTRICITY PILLAR

- . . COMMS PIT
- . . RING MAIN UNIT
- . . LIGHT POLE

- DESIGN CONTOURS
- EXISTING SURFACE CONTOURS
- DESIGN FILL

- SEWERAGE
- STORMWATER
- WATER PIPE
- UNDERGROUND ELECTRICITY
- COMMS LINE

- OPTIONAL BUILT TO BOUNDARY WALL
- FSL 3.44 FINISHED SURFACE LEVEL
- RETAINING WALL
- FOOTPATH
- RETAINING WALL HEIGHT

**Notes:**

- Final areas are subject to design changes, Council approval and field survey and may differ from those shown on this Disclosure Plan.
- Final presentation of areas will comply with requirements of the Registrar of Titles and may vary from the format on this Disclosure Plan
- "The Seller is entitled to make a Permitted Variation (as defined in Special Condition 3 of the contract) to the lot including its location, area, size, dimensions and elevation".
- Design contours are approximate only and may change during construction
- Services have been plotted from design information only and may change during construction
- All earthworks fill to lots has been placed and compacted on Level 1 basis in accordance with Australian Standard AS3798-2007 "Guidelines on earthworks for commercial and residential developments".

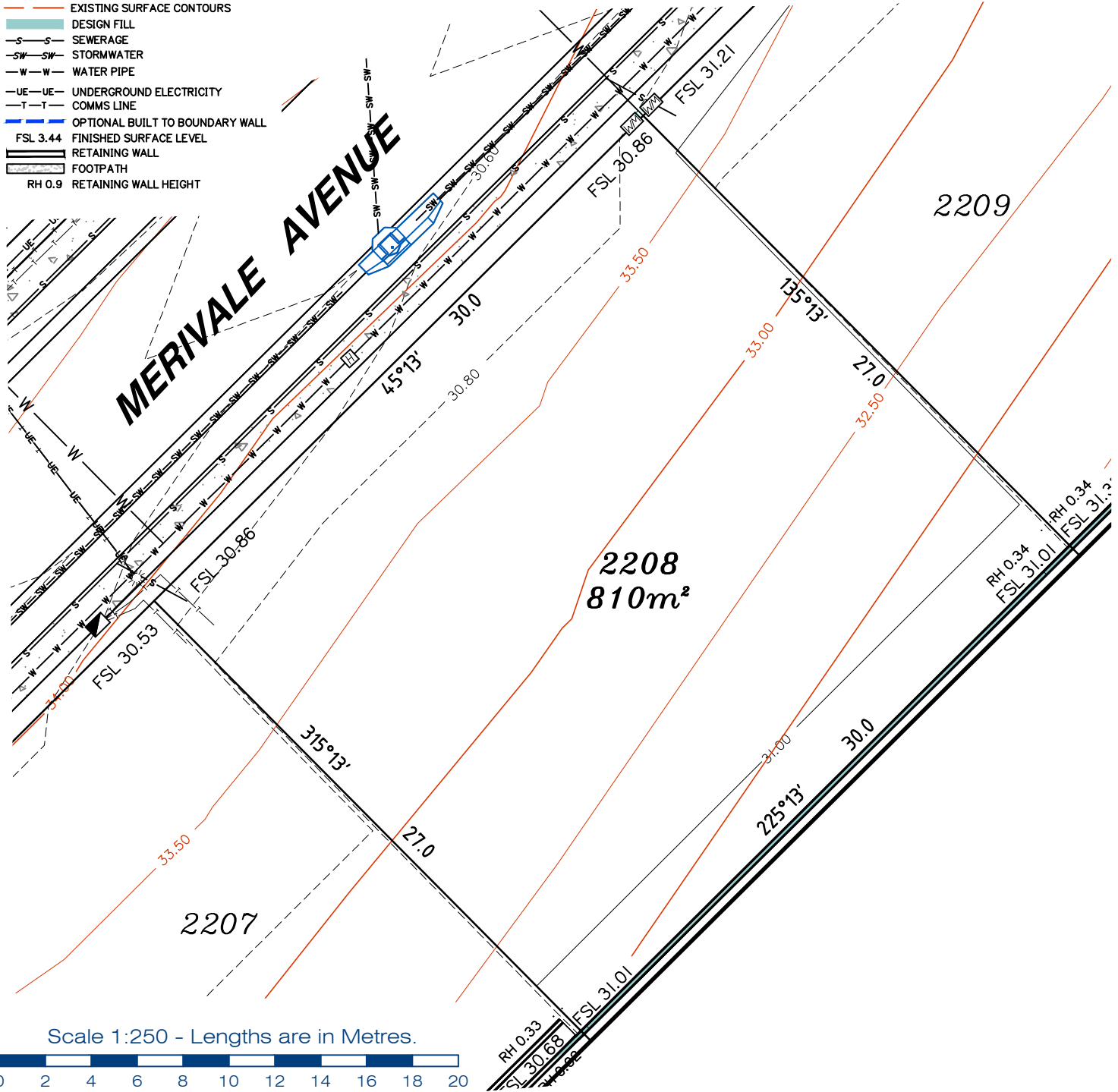

**gassman development perspectives**  
 est 1985  
 planning | environment | landscape | engineering | survey  
 T: 3807 3333 | F: 3287 5461 | www.gassman.com.au  
 LOGAN & Logan | 76 Business Street, Yatala QLD | PO Box 392, Beenleigh 4207

|         |  |
|---------|--|
| Client  | <b>AVJENNINGS Pty Ltd</b>  |
| Project | <b>DISCLOSURE PLAN</b><br><b>LOT 2208</b><br>(Survey plan: SP280871)<br><b>RIVERTON</b><br><b>Cusack Lane, Jimboomba</b> |

|                        |                    |                  |                               |
|------------------------|--------------------|------------------|-------------------------------|
| Locality               | JIMBOOMBA          | Issue Date       | 24/09/2021                    |
| Local Govt             | LOGAN CITY COUNCIL | Meridian         | SP280865                      |
| Scale (on A4 original) | 1:250              | Level Datum      | AHD                           |
|                        |                    | Contour Interval | 0.2 m Design<br>0.5m Existing |
|                        |                    | Drawn            | S.Chowdhury                   |
|                        |                    | Date Drafted     | 10/08/2021                    |
|                        |                    | Checked          | A.Geraghty                    |

**Real Property Description:**  
 Lot 701 on SP280865

**REFERENCE No. 5544-2D**  
**PLAN No. 5544 S DC LOT 2208**



**LEGEND**

- . . SEWER MANHOLE
- . . SEWER MAINTENANCE SHAFT
- . . SEWER RODDING END
- . . STORMWATER MANHOLE
- . . GULLY TRAP
- . . WATER METER
- . . FIRE HYDRANT
- . . STOP VALVE
- . . ELECTRICITY PILLAR
- . . COMMS PIT
- . . RING MAIN UNIT
- . . LIGHT POLE
- . . DESIGN CONTOURS
- . . EXISTING SURFACE CONTOURS
- . . DESIGN FILL
- . . SEWERAGE
- . . STORMWATER
- . . WATER PIPE
- . . UNDERGROUND ELECTRICITY
- . . COMMS LINE
- . . OPTIONAL BUILT TO BOUNDARY WALL
- . . RETAINING WALL
- . . FOOTPATH
- . . RH 0.9 RETAINING WALL HEIGHT

**Notes:**

- Final areas are subject to design changes, Council approval and field survey and may differ from those shown on this Disclosure Plan.
- Final presentation of areas will comply with requirements of the Registrar of Titles and may vary from the format on this Disclosure Plan
- "The Seller is entitled to make a Permitted Variation (as defined in Special Condition 3 of the contract) to the lot including its location, area, size, dimensions and elevation".
- Design contours are approximate only and may change during construction
- Services have been plotted from design information only and may change during construction
- All earthworks fill to lots has been placed and compacted on Level 1 basis in accordance with Australian Standard AS3798-2007 "Guidelines on earthworks for commercial and residential developments".

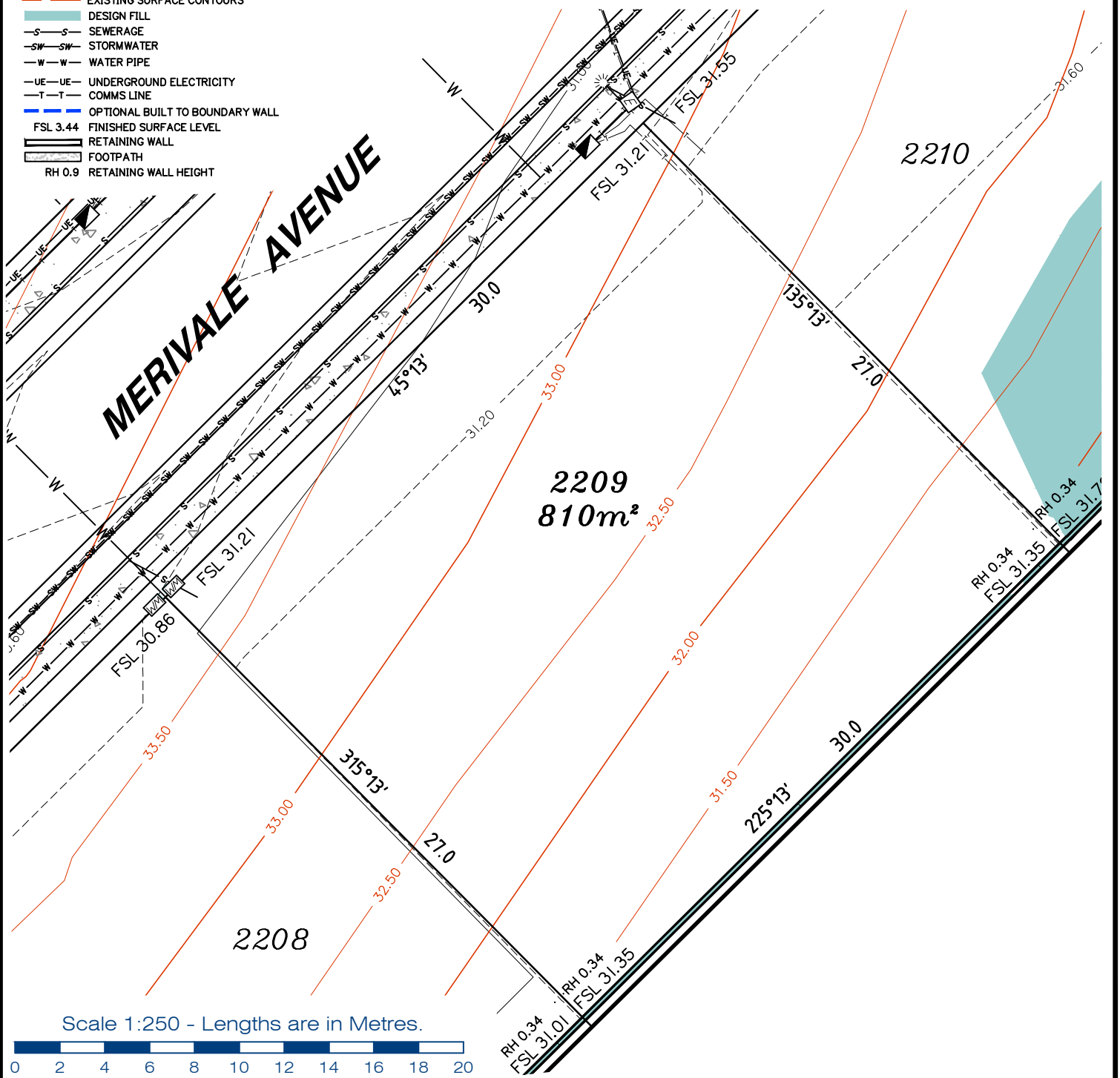

gassman  
development  
perspectives

est 1985

planning | environment | landscape | engineering | survey

T: 3807 3333 | F: 3287 5461 | www.gassman.com.au

LOGAN & Logan | 76 Business Street, Yatala QLD | PO Box 392, Beenleigh 4207

|                            |  |
|----------------------------|--|
| Client                     | <b>AVJENNINGS Pty Ltd</b>  |
| Project                    | <b>DISCLOSURE PLAN</b><br><b>LOT 2209</b><br>(Survey plan: SP280871)<br><b>RIVERTON</b><br><b>Cusack Lane, Jimboomba</b> |
| Real Property Description: | Lot 701 on SP280865  |

|                        |                           |                  |                               |
|------------------------|---------------------------|------------------|-------------------------------|
| Locality               | JIMBOOMBA                 | Issue Date       | 24/09/2021                    |
| Local Govt             | LOGAN CITY COUNCIL        | Meridian         | SP280865                      |
| Scale (on A4 original) | 1:250                     | Level Datum      | AHD                           |
| REFERENCE No.          | <b>5544-2D</b>            | Contour Interval | 0.2 m Design<br>0.5m Existing |
| PLAN No.               | <b>5544 S DC LOT 2209</b> | Drawn            | S.Chowdhury                   |
|                        |                           | Date Drafted     | 10/08/2021                    |
|                        |                           | Checked          | A.Geraghty                    |

**LEGEND**

- . . SEWER MANHOLE
- . . SEWER MAINTENANCE SHAFT
- . . SEWER RODDING END
- . . STORMWATER MANHOLE
- . . GULLY TRAP
- . . WATER METER
- . . FIRE HYDRANT
- . . STOP VALVE
- . . ELECTRICITY PILLAR
- . . COMMS PIT
- . . RING MAIN UNIT
- . . LIGHT POLE
- . . DESIGN CONTOURS
- . . EXISTING SURFACE CONTOURS
- . . DESIGN FILL
- . . SEWERAGE
- . . STORMWATER
- . . WATER PIPE
- . . UNDERGROUND ELECTRICITY
- . . COMMS LINE
- . . OPTIONAL BUILT TO BOUNDARY WALL
- FSL 3.44 FINISHED SURFACE LEVEL
- . . RETAINING WALL
- . . FOOTPATH
- RH 0.9 RETAINING WALL HEIGHT

**Notes:**

- Final areas are subject to design changes, Council approval and field survey and may differ from those shown on this Disclosure Plan.
- Final presentation of areas will comply with requirements of the Registrar of Titles and may vary from the format on this Disclosure Plan
- "The Seller is entitled to make a Permitted Variation (as defined in Special Condition 3 of the contract) to the lot including its location, area, size, dimensions and elevation".
- Design contours are approximate only and may change during construction
- Services have been plotted from design information only and may change during construction
- All earthworks fill to lots has been placed and compacted on Level 1 basis in accordance with Australian Standard AS3798-2007 "Guidelines on earthworks for commercial and residential developments".

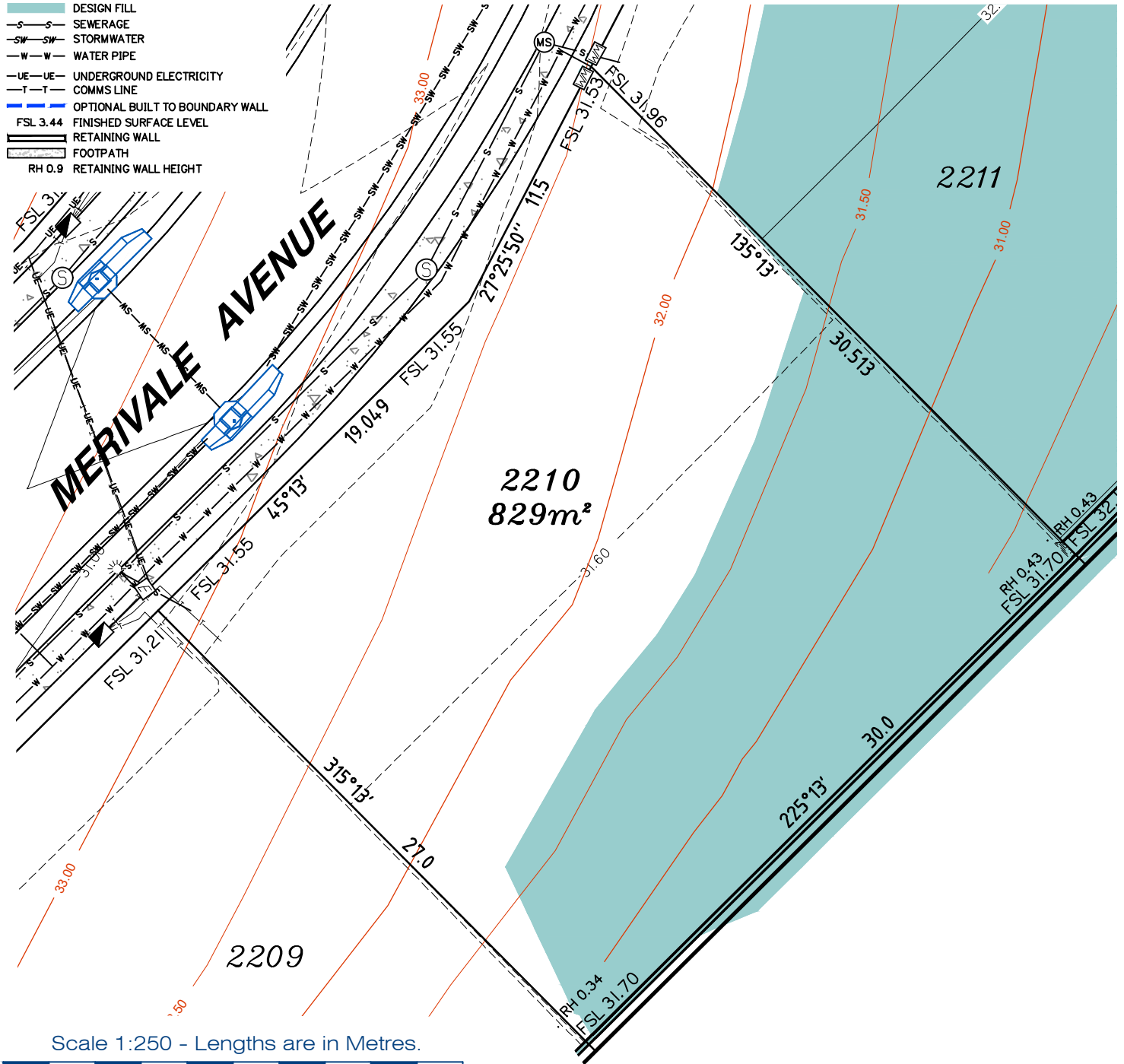

Scale 1:250 - Lengths are in Metres.



**gassman**  
**development**  
**perspectives**

est 1985

planning | environment | landscape | engineering | survey

T: 3807 3333 | F: 3287 5461 | www.gassman.com.au

LOGAN & Logan | 176 Business Street, Yatala QLD | PO Box 392, Beenleigh 4207

|         |  |
|---------|--|
| Client  | <b>AVJENNINGS Pty Ltd</b>  |
| Project | <b>DISCLOSURE PLAN</b><br><b>LOT 2210</b><br>(Survey plan: SP280871)<br><b>RIVERTON</b><br><b>Cusack Lane, Jimboomba</b> |

|                        |                    |                  |                               |
|------------------------|--------------------|------------------|-------------------------------|
| Locality               | JIMBOOMBA          | Issue Date       | 18/10/2021                    |
| Local Govt             | LOGAN CITY COUNCIL | Meridian         | SP280865                      |
| Scale (on A4 original) | 1:250              | Level Datum      | AHD                           |
|                        |                    | Contour Interval | 0.2 m Design<br>0.5m Existing |
|                        |                    | Drawn            | S.Chowdhury                   |
|                        |                    | Date Drafted     | 10/08/2021                    |
|                        |                    | Checked          | A.Geraghty                    |

**Real Property Description:**  
Lot 701 on SP280865

REFERENCE No. **5544-2D**  
PLAN No. **5544 S DC LOT 2210 A**



**LEGEND**

- . . . SEWER MANHOLE
- . . . SEWER MAINTENANCE SHAFT
- . . . SEWER RODDING END
- . . . STORMWATER MANHOLE
- . . . GULLY TRAP
- . . . WATER METER
- . . . FIRE HYDRANT
- . . . STOP VALVE
- . . . ELECTRICITY PILLAR
- . . . COMMS PIT
- . . . RING MAIN UNIT
- . . . LIGHT POLE
- . . . DESIGN CONTOURS
- . . . EXISTING SURFACE CONTOURS
- . . . DESIGN FILL
- . . . SEWERAGE
- . . . STORMWATER
- . . . WATER PIPE
- . . . UNDERGROUND ELECTRICITY
- . . . COMMS LINE
- . . . OPTIONAL BUILT TO BOUNDARY WALL
- . . . FINISHED SURFACE LEVEL
- . . . RETAINING WALL
- . . . FOOTPATH
- . . . RETAINING WALL HEIGHT

**Notes:**

- Final areas are subject to design changes, Council approval and field survey and may differ from those shown on this Disclosure Plan.
- Final presentation of areas will comply with requirements of the Registrar of Titles and may vary from the format on this Disclosure Plan
- "The Seller is entitled to make a Permitted Variation (as defined in Special Condition 3 of the contract) to the lot including its location, area, size, dimensions and elevation".
- Design contours are approximate only and may change during construction
- Services have been plotted from design information only and may change during construction
- All earthworks fill to lots has been placed and compacted on Level 1 basis in accordance with Australian Standard AS3798-2007 "Guidelines on earthworks for commercial and residential developments".

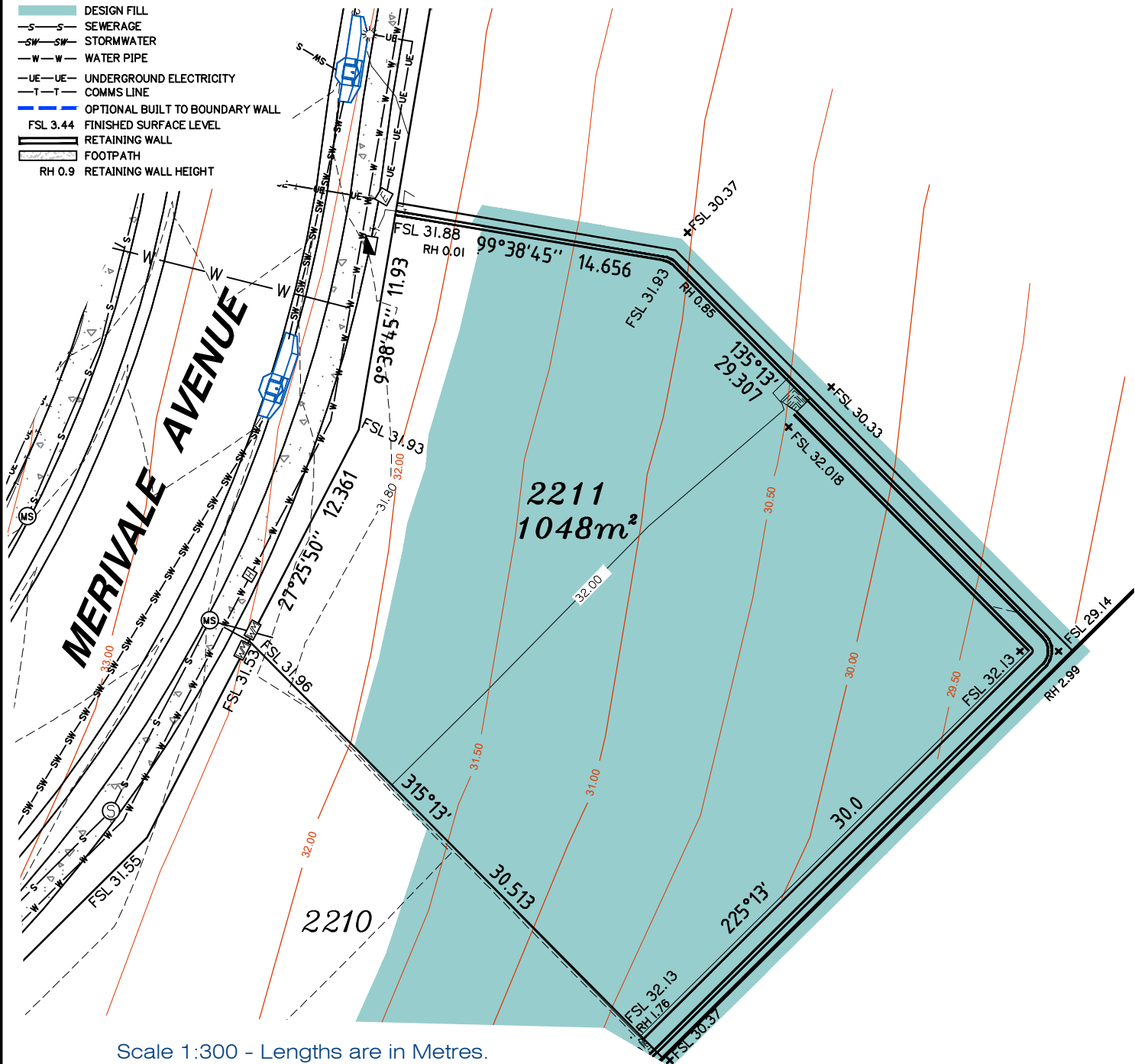

Scale 1:300 - Lengths are in Metres.



gassman  
development  
perspectives

est 1985

planning | environment | landscape | engineering | survey

T: 3807 3333 | F: 3287 5461 | www.gassman.com.au

LOGAN & Logan | 176 Business Street, Yatala QLD | PO Box 392, Beenleigh 4207

|         |  |
|---------|--|
| Client  | <b>AVJENNINGS Pty Ltd</b>  |
| Project | <b>DISCLOSURE PLAN</b><br><b>LOT 2211</b><br>(Survey plan: SP280871)<br><b>RIVERTON</b><br><b>Cusack Lane, Jimboomba</b> |

|                        |                    |                  |                               |
|------------------------|--------------------|------------------|-------------------------------|
| Locality               | JIMBOOMBA          | Issue Date       | 08/12/2021                    |
| Local Govt             | LOGAN CITY COUNCIL | Meridian         | SP280865                      |
| Scale (on A4 original) | 1:300              | Level Datum      | AHD                           |
|                        |                    | Contour Interval | 0.2 m Design<br>0.5m Existing |
|                        |                    | Drawn            | S.Chowdhury                   |
|                        |                    | Date Drafted     | 10/08/2021                    |
|                        |                    | Checked          | A.Geraghty                    |

**Real Property Description:**  
Lot 701 on SP280865

REFERENCE No. **5544-2D**  
PLAN No. **5544 S DC LOT 2211 B**